

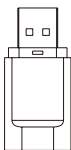

User Manual

2D Wireless & Bluetooth Barcode Scanner

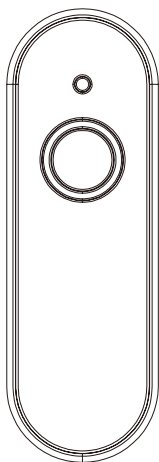

Model: M60

Contents

Factory Default.....	4
Wired Mode.....	5
Exit Wired Mode.....	5
Power Off.....	6
Technical Parameter.....	6
Warning.....	7
USB Receiver Pairing Instructions.....	8
Bluetooth Pairing Instructions.....	8
Keyboard ON or OFF in IOS device.....	12
Scan Mode.....	12
Data Saving Mode.....	12
Data Upload Instruction in Inventory Mode.....	13
Transmission Speed.....	13
Keyboard Caps Lock Control.....	14
Keyboard Language.....	14
Buzzer Setting.....	15
Sleep Time Setting.....	15
Barcode Settings.....	15
Barcode Conversion.....	18
Additional Code.....	19
End Character.....	21
Prefix Setting.....	21
Suffix Setting.....	21
Data Codes.....	22
FAQ.....	26



Factory Default



Wired Mode



Exit Wired Mode

Power Off



Note: Scan this barcode, scanner will make a beep and power off. Or long press the scanner button and hold for 15 seconds to power off.

Technical Parameter

Barcode Scanner	
Date Item	Parameter
Type of Light Source	617 nm LED white
Decoding Accuracy	≥4mil
Decoding Ability	1D: Code 128, EAN-13, ISBN, ISSN, EAN-8, EAN-128, UPC-A, UPC-E, UCC, Code 32, Code 93, Code 39, Code 39 Full ASCII, Codebar, Interleaved 2 of 5, Industrial 2 of 5, Standard 2 of 5, IATA 2 of 5, Matrix 2 of 5, MSI Plessy, ITF-14; 2D: QR Code, Micro QR Code, PDF-417, MicroPDF417, DataMatrix, Aztec Code, DM Code, Gs1, Gs1 QR Code
Scanning Principle	CMOS
Scan Mode	Manual Scan / Continuous Scan / Auto-sensing
Resolution	640x480px
The Distance Between The Scan And The Barcode	25mm-150mm (13mil 90%PCS)
Bit Error Rate	1/5 million
Data Saving Mode	Automatic Storage Mode (default) / Instant Upload Mode (Normal Mode) / Inventory Storage Mode
Storage Ability	512, 000 Bytes
Connection Ways	Bluetooth & 2.4Ghz Wireless & USB Wired
System Compatibility	iOS, Android, Windows, Linux
Material	ABS+PC
Interface	USB-HID
Working Current	280mA
Working Voltage	DC 5V±5%

Continue the table below ➡

◀ Continue to the table

Lithium Battery	800mA
Charging Time	2.5h
Battery Working	4h
Shock Resistance	Withstand multiple 3 meters free fall
Operating Temperature	-20°C~50°C
Storage Temperature	-40°C~70°C
Operating Humidity	5%-95% RH without condensation

⚠ Warning

1. Unboxing: Open the package and check if the accessories are complete. Package included: 1 x Barcode Scanner, 1 x 2.4G USB Receiver, 1 x USB Charging Cable, 1 x Manual. If there is any questions, please contact us at the first time. (email: support@obzshop.com)
2. Charging: LED1 green light always on; When charging is complete, LED1 off.
3. Do not scan the setting barcodes in the manual without instruction, it may cause barcode scanner not work properly.

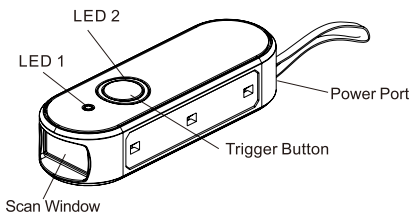

USB Receiver Pairing Instructions

Step 1: Scan below pairing barcode I and barcode II in sequence / or long press 8 seconds to enter pairing mode, the scanner LED1 indicator become flashing;

Step 2: Connect the USB receiver to host device and wait a second, the LED1 indicator always on blue both on scanner and USB receiver after succeed pair. Pairing completed.



I



II

Bluetooth Pairing Instructions

1. The Scanner Pair With Mobile Bluetooth Devices

Step 1: Scan below pairing barcode I and barcode II in sequence / or long press 8 seconds to enter pairing mode, the scanner LED1 indicator become flashing;

Step 2: Open the Bluetooth in the mobile bluetooth device and search for the barcode scanner which named "R&B40" (Picture①) and click pair (Picture②), wait a second, the barcode scanner LED1 indicator always on blue after succeed pair (Picture③). Pairing completed.



I



II

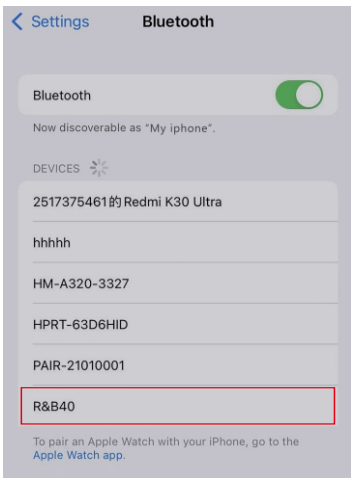

Picture ①

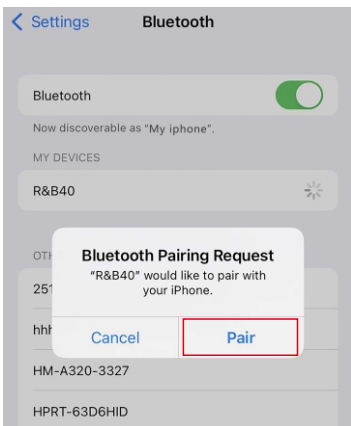

Picture ②

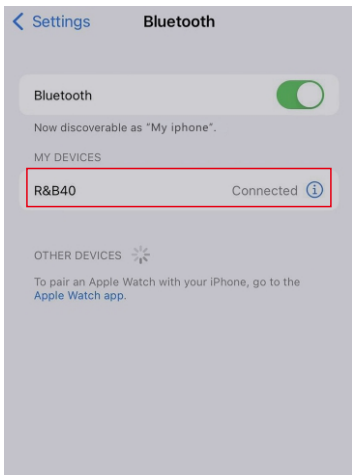

Picture③

2. The Scanner Pair With Computer Bluetooth Devices

- Step 1: Scan below pairing barcode I and barcode II in sequence / or long press 8 seconds to enter pairing mode, the scanner LED1 indicator become flashing;
- Step 2: Open the Bluetooth in the computer bluetooth device and search for the barcode scanner which named "R&B40" (Picture①) and click pair (Picture②), wait a second, the barcode scanner LED1 indicator always on blue after succeed pair (Picture③). Pairing completed.



I



II

Windows Bluetooth Connection:

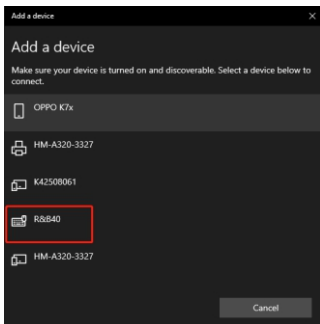

Picture ①

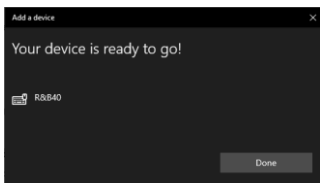

Picture②

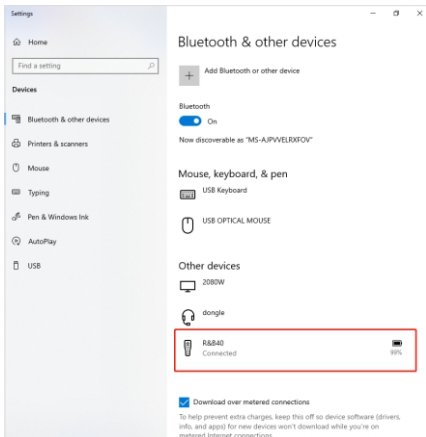

Picture③

Keyboard ON or OFF in IOS device



Note: Scan above QR code to enable or disable Keyboard in the IOS device.

Scan Mode



Manual(default)



Continuous



Auto-sensing

Data Saving Mode



Instant Upload



Automatic Storage
(default)



Inventory

Note:

- 1) Instant Upload Mode: The data will be uploaded to the device immediately after scan, out of range it will not save the data, and there will be alarm beeps out of range.
- 2) Automatic Storage Mode (default): If the scanner in range, the data will be uploaded to your device directly after scan; if the scanner out of range, will hear alarm beeps, the data will be saved in the memory chip. Press the scanner trigger to upload the saved data after back to range.
- 3) Inventory Mode: The data will be saved in the memory chip, you can upload data to your device by scan the set code in the manual. (Refer to "Data Upload Instruction in Inventory Mode")

Eg: Scan the "Upload all data", the scanner will upload all data saved in the memory chip.

Data Upload Instruction in Inventory Mode



Upload all data



Upload new data



Display all data



Display new data

Transmission Speed



No delay



Delay 10ms



Delay 20ms (default)



Delay 30ms

Keyboard Caps Lock Control



None(default)



Capitalize



Lower Case



Case Swap

Keyboard Language



USA(default)



French



UK



German



Italy



Spanish



Canada



Japanese

Buzzer Setting



ON(default)



OFF



High



Low

Sleep Time Setting



1Min



5Min(default)



10Min



None

Barcode Settings

Reverse Barcode Setting



Enable



Disable(default)

All 1D Barcodes



Enable



Disable

All 2D Barcodes



Enable



Disable

EAN-8



Enable



Disable

EAN-13



Enable



Disable

UPCA



Enable



Disable

UPC-E0



Enable



Disable

UPC-E1



Enable



Disable

Interleaved 2 of 5



Enable



Disable

Industrial 2 of 5



Enable



Disable

Codabar



Enable



Disable

Code 39



Enable



Disable

QR Code



Enable



Disable

PDF 417



Enable



Disable

DataMatrix



Enable



Disable

Barcode Conversion

EAN 13 Converts ISSN



Enable



Disable(default)

EAN 13 Converts ISBN



Enable



Disable(default)

UPCA Converts EAN13



Enable



Disable(default)

Additional Code

2-bit Additional Code for EAN-8



Enable



Disable(default)

5-bit Additional Code for EAN-8



Enable



Disable(default)

2-bit Additional Code for EAN-13



Enable



Disable(default)

5-bit Additional Code for EAN-13



Enable



Disable(default)

2-bit Additional Code for UPC-E1



Enable



Disable(default)

5-bit Additional Code for UPC-E1



Enable



Disable(default)

2-bit Additional Code for UPCA



Enable



Disable(default)

5-bit Additional Code for UPCA



Enable



Disable(default)

End Character



CR(default)



CR&LF



TAB



None

Prefix Setting



Add Prefix



Prefix

Eg: Add prefix "A"

Step 1: Scan above code to enter into "Add Prefix";

Step 2: Scan above code to add "Prefix";

Step 3: Scan the numeric code correspond to "A", the ASCII value of A in Hexadecimal is "4" "1"
(Refer to Appendix 1 & Appendix 2);

Step 4: Scan "saved" code to save (Refer to Appendix 1).

Suffix Setting



Add Suffix



Suffix

Note: The method of adding the suffix is the same as the prefix.

Data Codes

Appendix 1:



0



1



2



3



4



5



6



7



8



9



A



B



C



D



E



F



Save

Appendix 2 :

Hex	Char
00	NUL (Null char.)
01	SOH (Start of Header)
02	STX (Start of Text)
03	ETX (End of Text)
04	EOT (End of Transmission)
05	ENQ (Enquiry)
06	ACK (Acknowledgment)
07	BEL (Bell)
08	BS (Backspace)
09	HT (Horizontal Tab)
0a	LF (Line Feed)
0b	VT (Vertical Tab)
0c	FF (Form Feed)
0d	CR (Carriage Return)
0e	SO (Shift Out)
0f	SI (Shift In)
10	DLE (Data Link Escape)
11	DC1 (XON) (Device Control 1)
12	DC2 (Device Control 2)
13	DC3 (XOFF) (Device Control 3)
14	DC4 (Device Control 4)
15	NAK (Negative Acknowledgment)
16	SYN (Synchronous Idle)
17	ETB (End of Trans. Block)
18	CAN (Cancel)
19	EM (End of Medium)
1a	SUB (Substitute)
1b	ESC (Escape)
1c	FS (File Separator)
1d	GS (Group Separator)
1e	RS (Request to Send)
1f	US (Unit Separator)
20	SP (Space)
21	! (Exclamation Mark)
22	" (Double Quote)
23	# (Number Sign)
24	\$ (Dollar Sign)
25	% (Percent)
26	& (Ampersand)
27	' (Single Quote)
28	((Right / Closing Parenthesis)
29) (Right / Closing Parenthesis)
2a	* (Asterisk)
2b	+ (Plus)
2c	, (Comma)
2d	- (Minus / Dash)
2e	. (Dot)
2f	/ (Forward Slash)
30	0
31	1

Hex	Char
40	@ (AT Symbol)
41	A
42	B
43	C
44	D
45	E
46	F
47	G
48	H
49	I
4a	J
4b	K
4c	L
4d	M
4e	N
4f	O
50	P
51	Q
52	R
53	S
54	T
55	U
56	V
57	W
58	X
59	Y
5a	Z
5b	[(Left / Opening Bracket)
5c	\ (Back Slash)
5d] (Right / Closing Bracket)
5e	^ (Caret / Circumflex)
5f	_ (Underscore)
60	' (Grave Accent)
61	a
62	b
63	c
64	d
65	e
66	f
67	g
68	h
69	i
6a	j
6b	k
6c	l
6d	m
6e	n
6f	o
70	p
71	q

Continue the table below ➡

◀ Continue to the table

32	2
33	3
34	4
35	5
36	6
37	7
38	8
39	9
3a	: (Colon)
3b	: (Semi-colon)
3c	< (Less Than)
3d	= (Equal Sign)
3e	> (Greater Than)
3f	? (Question Mark)

72	r
73	s
74	t
75	u
76	v
77	w
78	x
79	y
7a	z
7b	{ (Left/ Opening Brace)
7c	(Vertical Bar)
7d	} (Right/Closing Brace)
7e	~ (Tilde)
7f	DEL (Delete)

FAQ:

1. Q: Why does the USB receiver show a driver error when connected to the computer? How to deal with it?

A: Please check whether the computer USB port is normal, and replace the other USB port to test.

For more setting, welcome to contact us for tech support.

Service support: support@obzshop.com

THANK YOU FOR CHOOSING OBZ.

